

8 7 6 5 4 3 2 1

F F

- NOTES:
- 2 LASER CUT PARTS : MOTOR SIDE FLANGE, SCREW SIDE FLANGE
 - ALIGN THE BOLT PATTERNS BY INSERTING SCREWS & NUTS IN A FEW HOLES.
 - POINT WELD THE PARTS.
 - TIG WELD ALL AROUND THE FLANGES FILLING THE CHAMFERS.

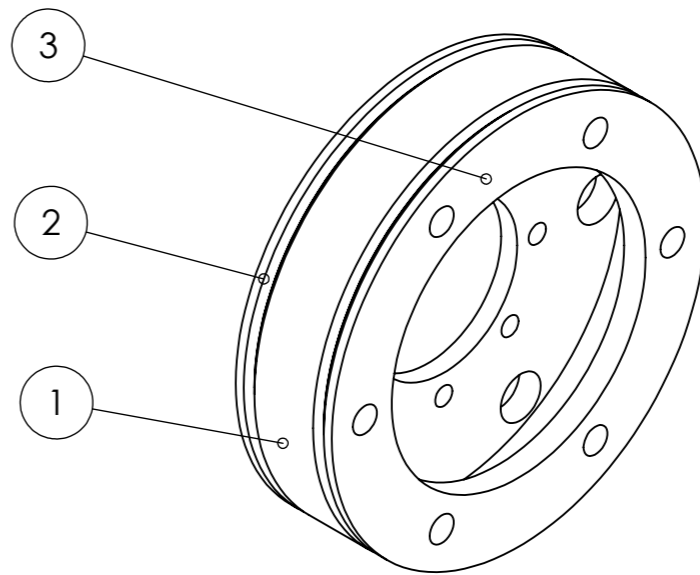
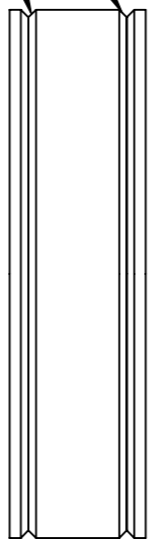
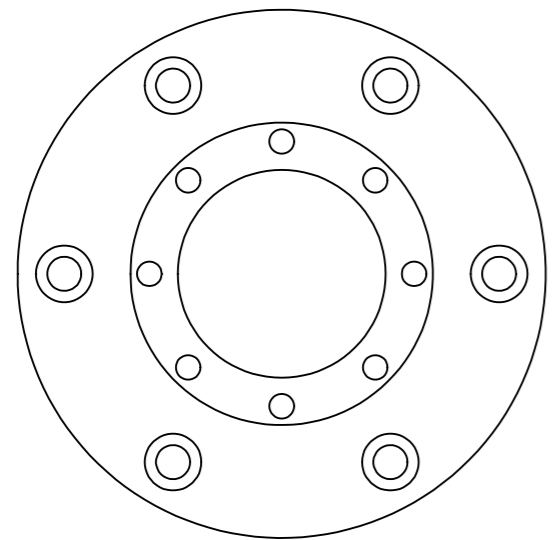

D C B A

F E D C B A

3	1	Motor side flange	EXTPRO-V1 1110.03	Mild Steel
2	1	Screw side flange	EXTPRO-V1 1110.02	Mild Steel
1	1	Flange spacer	EXTPRO-V1 1110.01	Mild Steel
ITEM NO.	QTY.	DESCRIPTION	PART NO.	MATERIAL



Machine Extruder PRO	Description Gearbox flange			
Projection method: First angle	Release date 07/01/20	Drawing no. EXTPRO-V1 1110.00	Rev. A	
General tolerances ISO 2768-m	Doc. type Assembly	Units unless specified mm	Sheet size A3	Scale 1:2
			Sheet 1 / 1	

8 7 6 5 4 3 2 1

A

A