

8 7 6 5 4 3 2 1

F
E
D
C
B
A

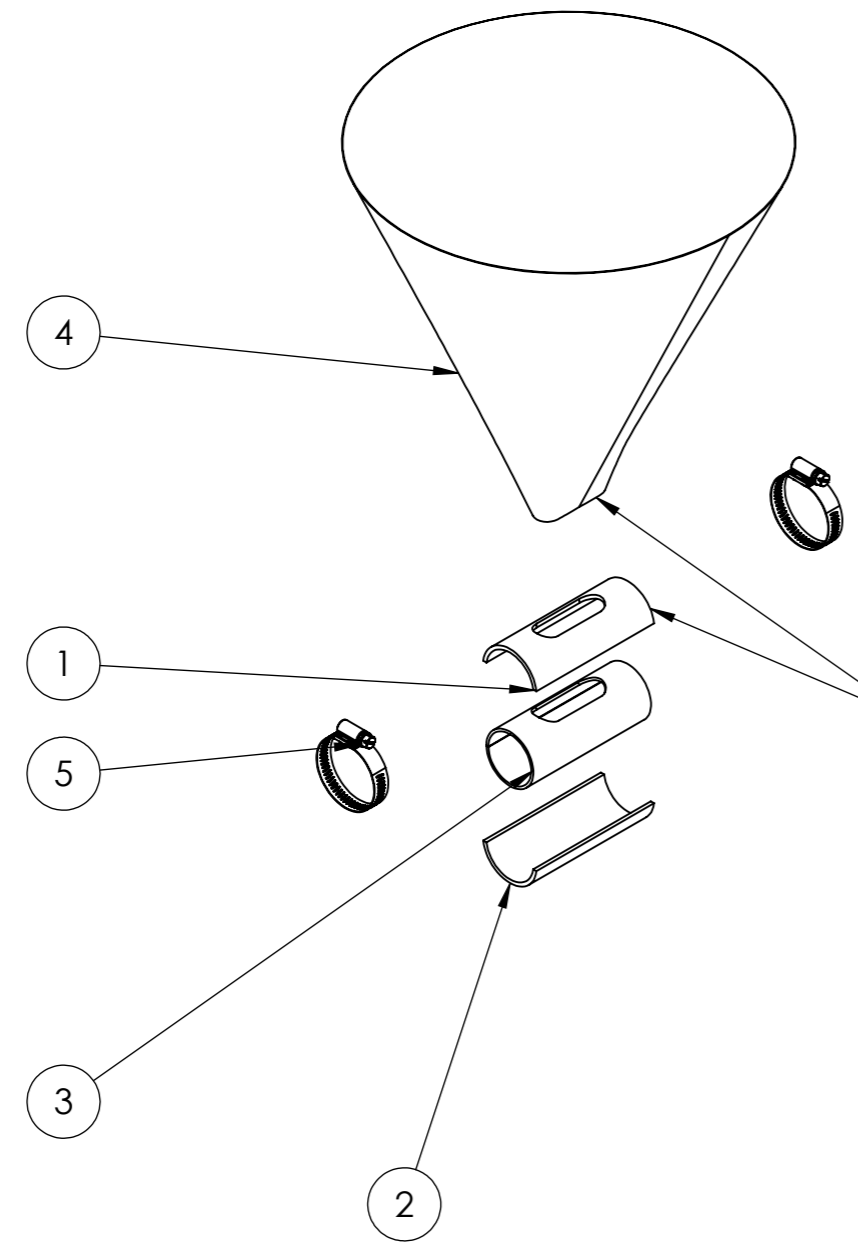

Carefully weld Item 4 onto Item 1. Be careful not to go through.
Welding from inside the Item 1 and sanding afterwards might be easier.

ITEM NO.	QTY.	DESCRIPTION	PART NO.	MATERIAL
5	2	Worm drive clamp 50 mm	EXTPRO-V1 10	Steel
4	1	Cone	EXTPRO-V1 1200.04	Mild Steel
3	1	Insulation	EXTPRO-V1 1200.03	Insulation Paper
2	1	Bottom	EXTPRO-V1 1200.02	Mild Steel
1	1	Top	EXTPRO-V1 1200.01	Mild Steel

	Machine Extruder PRO		Description Cone Hopper Assembly			
	Projection method: First angle		Release date 07/01/20	Drawing no. EXTPRO-V1 1201.00		Rev. A
	General tolerances ISO 2768-m		Doc. type Assembly	Units unless specified mm	Sheet size A3	Scale 1:3

8 7 6 5 4 3 2 1

F
E
D
C
B
A