

8 7 6 5 4 3 2 1

F
E
D
C
B
A

F
E
D
C
B
A

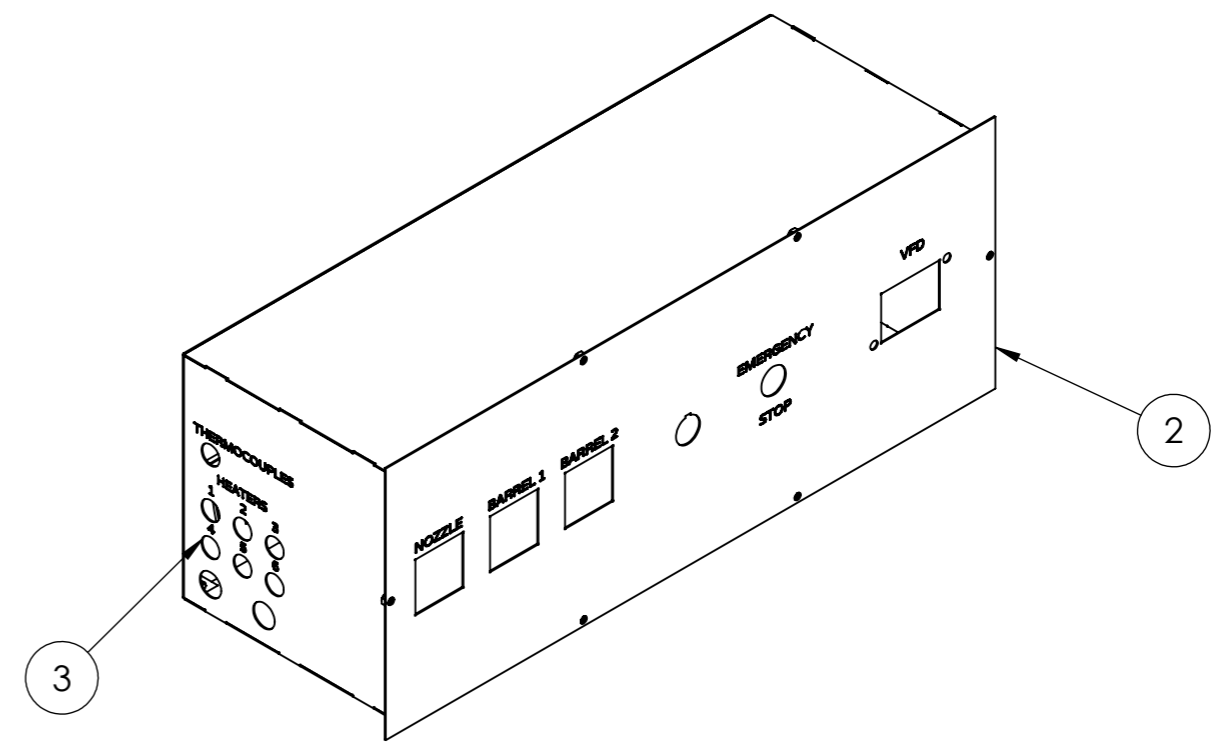
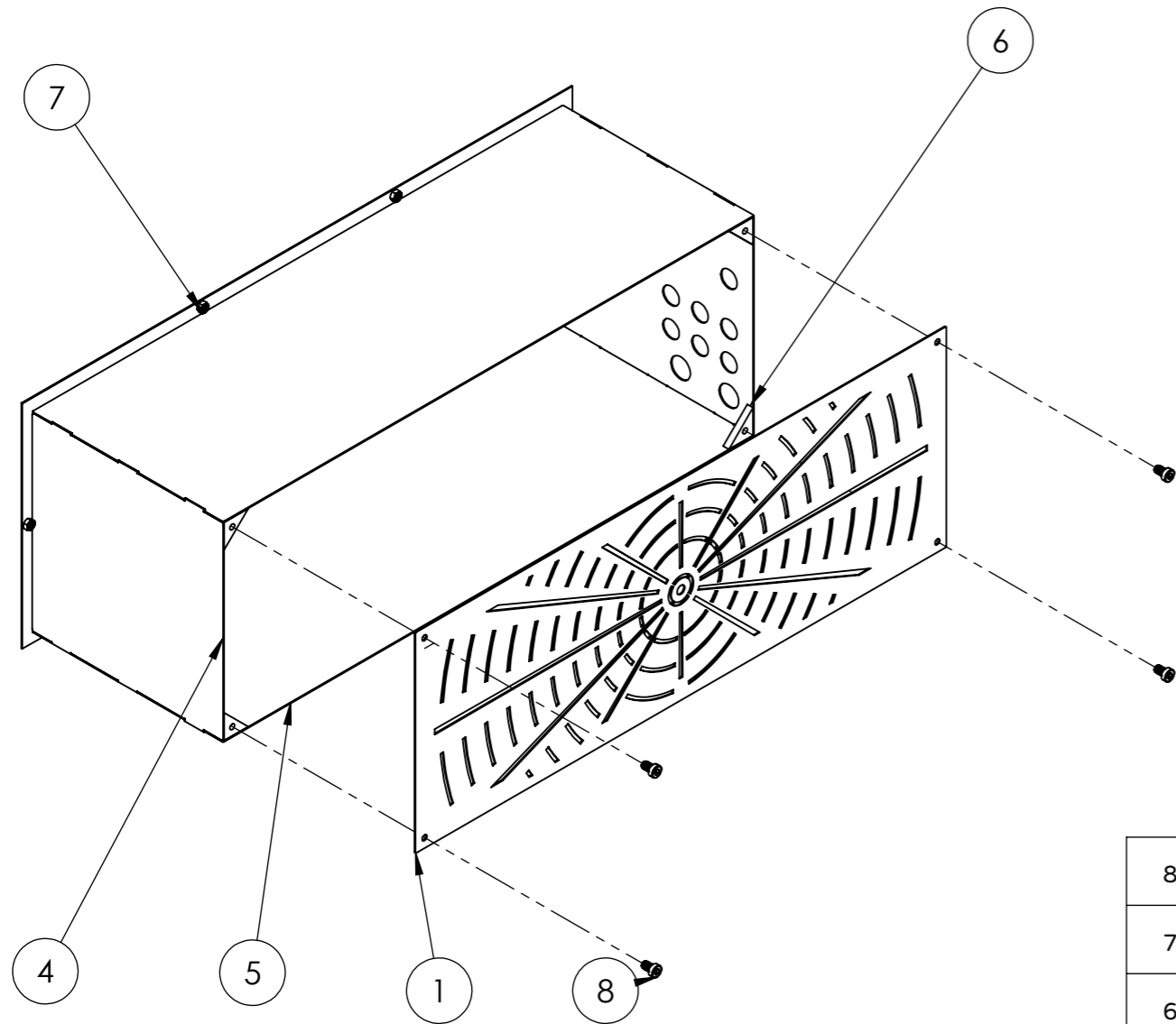

8	4	M6 x 10 mm Socket Head Screw DIN 7984	EXTPRO-V1 15	Steel
7	6	M5 Hex. Nut DIN 934	EXTPRO-V1 14	Steel
6	4	Cover attachment Thick. 1 mm	EXTPRO-V1 2100.06	Mild Steel
5	2	Side 3 Thick. 1 mm	EXTPRO-V1 2100.05	Mild Steel
4	1	Side 1 Thick. 1 mm	EXTPRO-V1 2100.04	Mild Steel
3	1	Side 2 Thick. 1 mm	EXTPRO-V1 2100.03	Mild Steel
2	1	Front Thick. 1 mm	EXTPRO-V1 2100.02	Mild Steel
1	1	Cover Thick. 1 mm	EXTPRO-V1 2100.01	Mild Steel
ITEM NO.	QTY.	Numéro de pièce	PART NO.	MATERIAL

-Items 1 through 6 are laser cut. Find corresponding .DXF files in the download kit.
 -Point weld together items 2 through 6
 -Align the M5 nuts (EXTPRO-V1 14) on the holes with bolts and point weld the nuts in place

	Machine Extruder PRO		Description Extruder Assembly		
	Projection method: First angle		Release date 07/01/20	Drawing no. EXTPRO-V1 2100.00	Rev. A
	General tolerances ISO 2768-m	Doc. type Assembly	Units unless specified mm	Sheet size A3	Scale 1:5

8 7 6 5 4 3 2 1